

# 1 Amp Schottky Rectifier LSM140, 145, 150

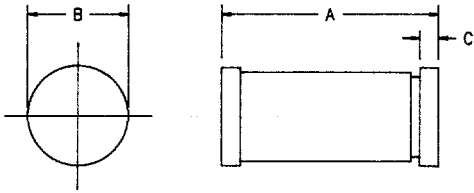

Dim.	Inches		Millimeter		Notes
	Minimum	Maximum	Minimum	Maximum	
A	.189	.205	4.80	5.20	
B	.094	.105	2.39	2.66	Dia.
C	.016	.022	.41	.55	

GLASS HERMETIC DO213AB

Microsemi Catalog Number	Working Peak Reverse Voltage	Repetitive Peak Reverse Voltage	
LSM140	40V	40V	<ul style="list-style-type: none"> <li>• Low Forward Voltage</li> <li>• Schottky Barrier Rectifier</li> <li>• Guard Ring Protection</li> <li>• 150°C Junction Temperature</li> <li>• VRRM 40 to 50 Volts</li> </ul>
LSM145	45V	45V	
LSM150	50V	50V	

Electrical Characteristics		
Average forward current	I <sub>F(AV)</sub> 1.0 Amps	T <sub>A</sub> = 124°C, Square wave, R <sub>θJC</sub> = 45°C/W
Maximum surge current	I <sub>FSM</sub> 75 Amps	8.3ms, half sine, T <sub>J</sub> = 150°C
Max peak forward voltage	V <sub>FM</sub> .39 Volts	I <sub>FM</sub> = 0.1A; T <sub>J</sub> = 25°C*
Max peak forward voltage	V <sub>FM</sub> .58 Volts	I <sub>FM</sub> = 1.0A; T <sub>J</sub> = 25°C*
Max peak reverse current	I <sub>RM</sub> 1.0 mA	V <sub>R</sub> = 5.0V, T <sub>J</sub> = 25°C
Typical junction capacitance	C <sub>J</sub> 60pF	V <sub>R</sub> = 5.0V, T <sub>J</sub> = 25°C
*Pulse test: Pulse width 300 μsec, Duty cycle 2%		

Thermal and Mechanical Characteristics		
Storage temperature range	T <sub>STG</sub>	-65° to 150°C
Operating junction temp range	T <sub>J</sub>	-65° to 150°C
Maximum thermal resistance	R <sub>θJC</sub>	45°C/W Junction to Case
Weight		.0047 ounces (0.12 grams) typical

PH: 303-469-2161  
FAX: 303-466-3775

**Microsemi Corp.**  
**Colorado**

C-7

# LSM140, 145, 150

Figure 1  
Maximum Forward Characteristics

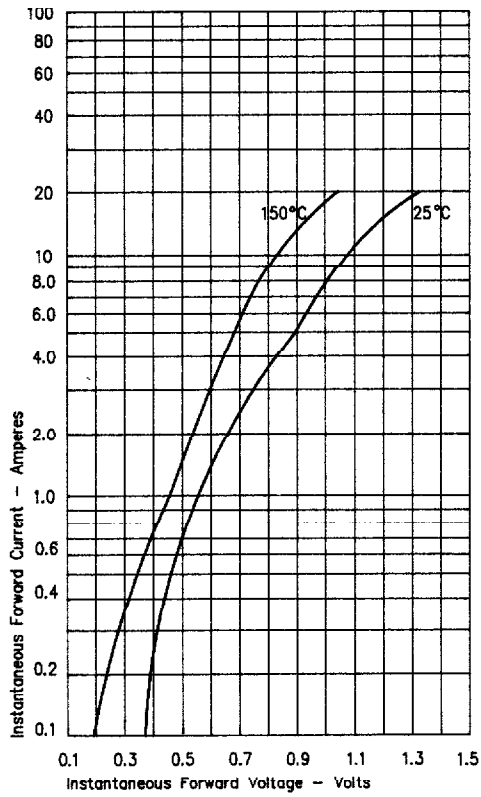

Figure 3  
Typical Junction Capacitance

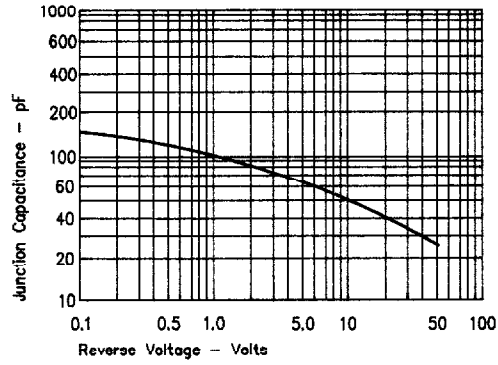

Figure 2  
Typical Reverse Characteristics

